



### ZE WORM GEAR WINCHES

Model ZE is a DC electric worm gear winch with steel spur gear reduction. Designed for extended life and gives best safe duty. This winch is built according with higher safety standards in compliance with Directive Machinery 2006/42/CE EN 14492-1. The special aluminium alloy bronze gear match to an hardened steel ground polished worm. Worm gear provides load reversing protection. It is suitable to be mounted on vehicle where hydraulic system is not available. Its particular design makes it proper for front end or rear trucks mounting.

### FEATURES

- TOUGH**  
The special aluminium alloy bronze gear match to an hardened steel ground polished worm
- MOUNTING**  
Designed for either foot or side mounting, make it proper for front end or rear vehicles mounting
- LIGHT AND STRONG**  
Body manufactured from hardened special aluminium castings, reducing weight and increasing strength  
Powder coat finished
- BRAKE**  
Worm gear provides load reversing protection

### WINCHES RANGE

MODEL	PULLING CAPACITY
ZEC 2700 - ZEL 2700	2.700 Kgs. (6.000 Lbs.)
ZEC 3600 - ZEL 3600	3.600 Kgs. (8.000 Lbs.)

- DRUM SIZE AVAILABLE**  
Short: 160 mm (6.3 inch) for ZEC  
Long: 240 mm (9.4 inch) for ZEL
- TOTALLY OIL COOLED**  
Worm and gear in oil bath and Spur gears lubricated for the entire life with grease, give best performance and extending parts life
- ACCESSORIES :**
  - Zinc plated Heavy-duty roller fairlead
  - Zinc plated Cable tensioner
  - Spacers (for winch mounting)

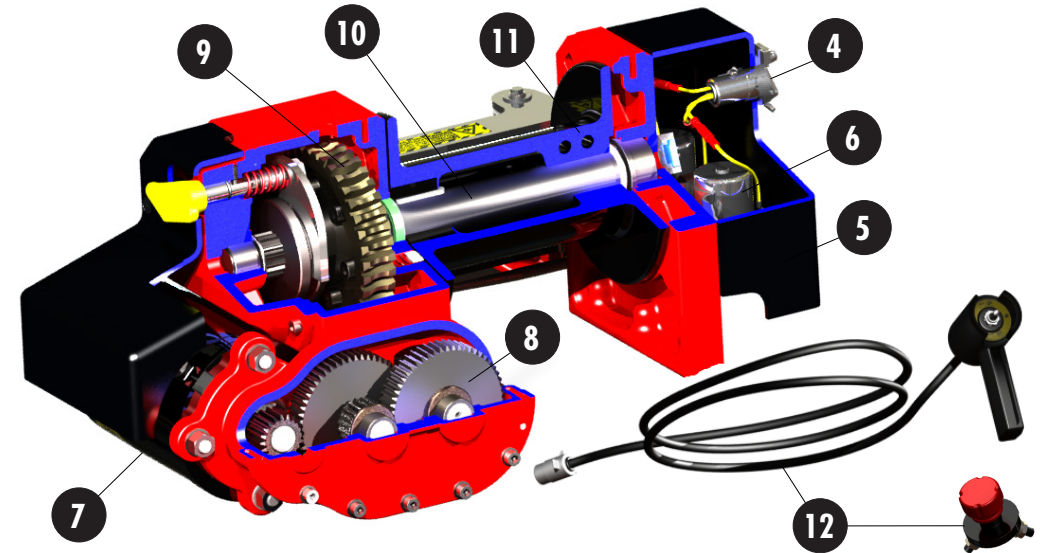

### COMPONENTS

- 1. LOAD LIMITING DEVICE**  
Load limiting device, designed to provide mechanical overload protection as safety measures. It doesn't suffer overheating as electronic devices does.
- 2. HEAVY-DUTY ROLLER FAIRLEAD**  
Zinc plated heavy-duty roller fairlead.
- 3. MANUAL CLUTCH**  
Manual clutch for drum free spooling.
- 4. SOCKET**
- 5. POWER SUPPLY STUD (+)**
- 6. SOLENOIDS**  
Heavy-duty metal case solenoids switch.
- 7. ELECTRIC MOTOR**  
Electric motor IP 55 protection. Ground wired onto the body. Painted finish.
- 8. PRIMARY GEAR REDUCTION**  
Steel shaving spur gears in hardened special aluminium castings.
- 9. FINAL GEAR REDUCTION**  
A special aluminium alloy bronze gear match to an hardened steel ground polished worm in hardened special aluminium castings.
- 10. MAIN SHAFT**  
Hardened steel main shaft.
- 11. DRUM**  
Dual rope anchor point based on Vime's own design in compliance with CE Directive Machinery to prevent rope release.
- 12. REMOTE CONTROL**  
Remote control switch assembly (includes plug and cable 4 Mt.(13,12 Ft.) provides control of the forward or reverse rotation of the spooling drum.  
Battery leads 2 Mt.(6,56 Ft.), Battery switch.  
Ground cable 2 Mt.(6,56 Ft.).

## ZEC ZEL 23600 27000 MANUAL CLUTCH VERSION

### 12V



CE  
EN 14492-1

ZE winches are equipped with manual clutch shifter. Clutch allows the operator to manually disengage the spooling drum from the gear train, enabling the drum to rotate freely (freespooling). Engaging the clutch, it locks the winch drum back onto the gear train.

### DIMENSIONAL DATA

Dimensions are :  
Inch  
Millimeters

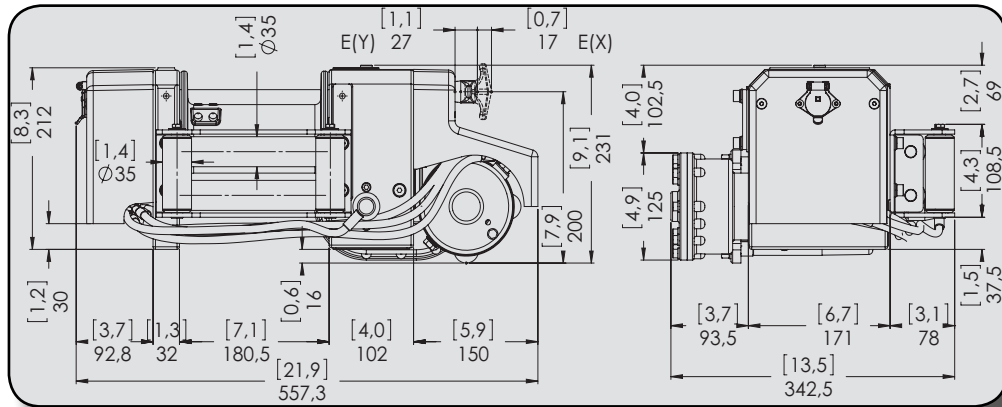

### TECHNICAL DATA

VOLTAGE	LINE PULL		GEAR RATIO	NO LOAD		MAX. LINE PULL		WIRE ROPE SIZE		WIRE ROPE CAPACITY		MAX. WIRE ROPE CAPAC. EN 14492-1		MAX. WIRE ROPE CAPAC. **		DESCRIPTION	WEIGHT LBS		WEIGHT KGS												
	1st LAYER	2nd LAYER		1st LAYER	2nd LAYER	INCH	MM	FT	MT	FT	MT	FT	MT	FT	MT		ZEC	ZEL	ZEC	ZEL											
[V]	LBS	KGS		LINE SPEED		CURRENT	LINE SPEED		CURRENT	INCH	MM	FT	MT	FT	MT	FT	MT	FT	MT	WINCH (without wire rope)	ZEC	ZEL	ZEC	ZEL							
				FT/MIN	MT/MIN	[A]	FT/MIN	MT/MIN	[A]																						
12V	8.000	3.600	392:1	18,0	5,5	65	2,3	0,7	290	-	9	49	15	82	25	56	17	85	26	75	23	167	51	8,8	11,0	4,0	5,0	67,2	88,2	30,5	40,0
	6.000	2.700	298:1	23,6	7,2	70	6,2	1,9	260	-	8	55	17	82	25	62	19	95	29	98	30	180	55	3,1	4,2	1,4	1,8	3,1	4,2	1,4	1,8

Electric motor.....12V DC (1,9 Hp)



### WARNING

Do not use winch to lift support or transport personnel.

## ZEC ZEL 23600 27000 MANUAL CLUTCH VERSION

### 12V



CE  
EN 14492-1

ZE winches are equipped with manual clutch shifter. Clutch allows the operator to manually disengage the spooling drum from the gear train, enabling the drum to rotate freely (freespooling). Engaging the clutch, it locks the winch drum back onto the gear train.

### DIMENSIONAL DATA

Dimensions are :  
Inch  
Millimeters

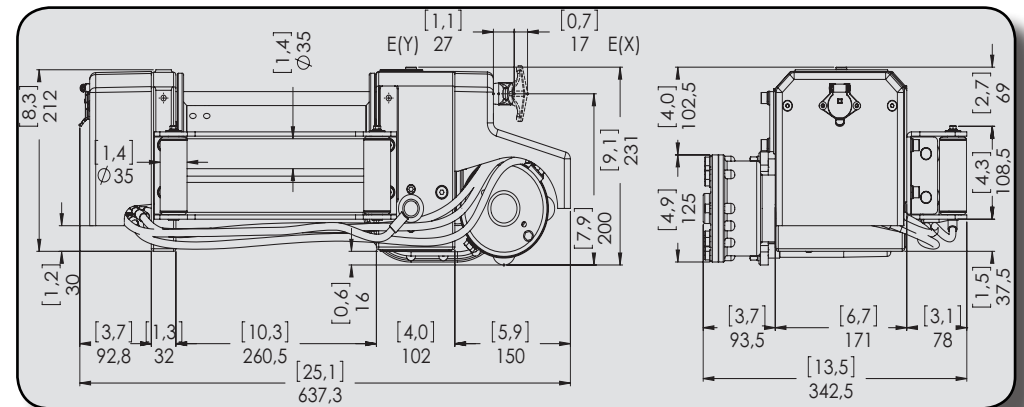

\*\* Max wire rope capacity corresponding to the full drum condition.



**NOTE:** Wire rope size must be respected. Recommended wire rope min.tensile strength 2160 N/mm<sup>2</sup>.

Wire rope minimum breaking load must be at least double of winch max. pulling capacity.

Max.wire rope capacity according with EN 14492-1.



**NOTE:** Specifications are subject to change without notification and without incurring obligation.

Specifications in this publication are theoretical and may vary depending on electric system, environment, etc.

## ZEC ZEL 23600 27000 MANUAL CLUTCH VERSION

### 24V



CE  
EN 14492-1

ZE winches are equipped with manual clutch shifter. Clutch allows the operator to manually disengage the spooling drum from the gear train, enabling the drum to rotate freely (freespooling). Engaging the clutch, it locks the winch drum back onto the gear train.

### DIMENSIONAL DATA

Dimensions are :  
Inch  
Millimeters

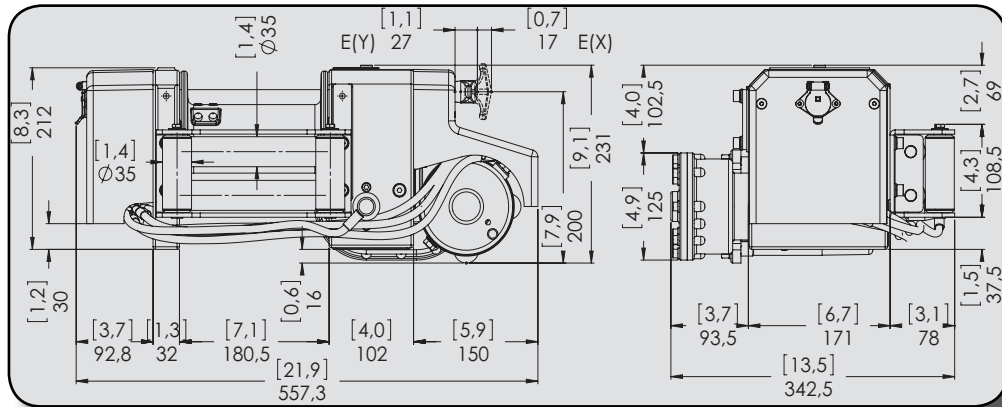

### TECHNICAL DATA

VOLT	LINE PULL		GEAR RATIO	NO LOAD		MAX. LINE PULL		WIRE ROPE SIZE		WIRE ROPE CAPACITY		MAX. WIRE ROPE CAPAC. EN 14492-1		MAX. WIRE ROPE CAPAC. **		DESCRIPTION	WEIGHT LBS		WEIGHT KGS										
	1st LAYER					1st LAYER		INCH	MM	FT	MT	FT	MT	FT	MT		FT	MT	ZEC	ZEL	ZEC	ZEL							
[V]	LBS	KGS		LINE SPEED		CURRENT	LINE SPEED		CURRENT																				
				FT/MIN	MT/MIN	[A]	FT/MIN	MT/MIN	[A]																				
24V	8.000	3.600	392:1	18,0	5,5	30	2,3	0,7	145	-	9	49	15	82	25	56	17	85	26	75	23	167	51	WINCH (without wire rope)	67,2	88,2	30,5	40,0	
	6.000	2.700	298:1	23,6	7,2	35	6,2	1,9	135	-	8	55	17	82	25	62	19	95	29	98	30	180	55	ACCESSORY: ROLLER FAIRLEAD	8,8	11,0	4,0	5,0	
																									ACCESSORY: CABLE TENSIONER	3,1	4,2	1,4	1,8

Electric motor.....24V DC (2,5 Hp)



### WARNING

Do not use winch to lift support or transport personnel.

## ZEC ZEL 23600 27000 MANUAL CLUTCH VERSION

### 24V



CE  
EN 14492-1

ZE winches are equipped with manual clutch shifter. Clutch allows the operator to manually disengage the spooling drum from the gear train, enabling the drum to rotate freely (freespooling). Engaging the clutch, it locks the winch drum back onto the gear train.

### DIMENSIONAL DATA

Dimensions are :  
Inch  
Millimeters

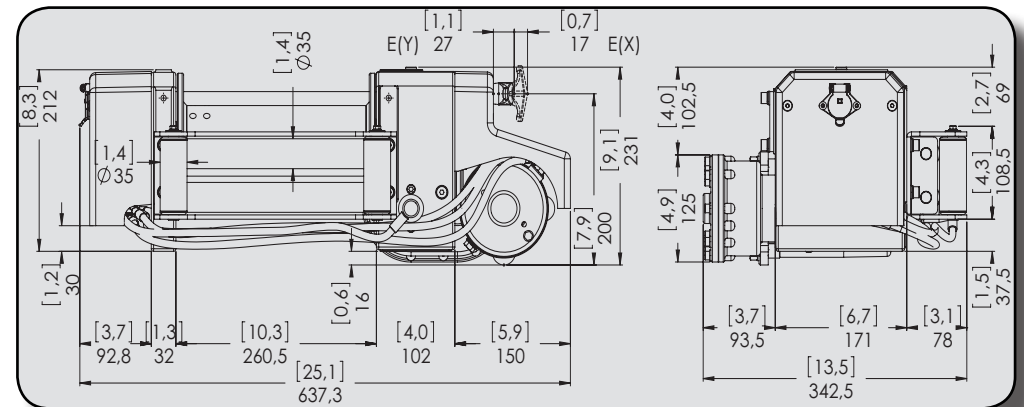

\*\* Max wire rope capacity corresponding to the full drum condition.



**NOTE:** Wire rope size must be respected. Recommended wire rope min.tensile strength 2160 N/mm<sup>2</sup>.

Wire rope minimum breaking load must be at least double of winch max. pulling capacity.

Max.wire rope capacity according with EN 14492-1.



**NOTE:** Specifications are subject to change without notification and without incurring obligation.

Specifications in this publication are theoretical and may vary depending on electric system, environment, etc.